

## Splashproof 16 and 32 Amp International Devices



- Ground contact in forward position to ensure first make, last break, neutral contact connects next, then phase contacts
- Neoprene sealing glands seal out moisture and contaminants at cord entry
- Gland nut and ring compress sealing gland around cord to seal out contaminants
- Solid brass pins provide contact reliability and superior conductivity

## Splashproof 16A and 32A International Ratings



Amps	Poles/ Wires	Configuration		Voltage	Receptacle	Plug	Connector	Back Box*
		Recep./ Conn.	Plug/ Inlet					
16	2P 3W			100-130V	316R4S	316P4S	316C4S	BB201WA BB301WA
	2P 3W			200-250V	316R6S	316P6S	316C6S	BB201WA BB301WA
	3P 4W			380-415V	416R6S	416P6S	416C6S	BB201WA BB301WA
	4P 5W			200/346V 240/415V	516R6S	516P6S	516C6S	BB201WA BB301WA
32	2P 3W			100-130V	332R4S	332P4S	332C4S	BB201WA BB301WA
	2P 3W			200-250V	332R6S	332P6S	332C6S	BB201WA BB301WA

Note: \*Requires AP2030 adapter plate, ordered separately (page J-8). Also see direct mounting back box DM20301 (page J-8).

## Product Dimensions Inches (mm)

	Plug			
	16A			32A
	3-Wire	4-Wire	5-Wire	3-Wire
A	1.99" (51.0)	2.26" (58.0)	2.50" (64.0)	2.57" (66.0)
B	5.38" (138.0)	5.38" (138.0)	5.58" (143.0)	6.83" (175.0)
C	3.99" (102.0)	3.99" (102.0)	4.17" (107.0)	5.07" (130.0)
D	0.66" (17.0)	0.66" (17.0)	0.66" (17.0)	0.96" (24.5)

	Connector			
	16A			32A
	3-Wire	4-Wire	5-Wire	3-Wire
A	1.99" (51.0)	2.26" (58.0)	2.50" (64.0)	2.57" (66.0)
B	5.85" (150.0)	5.89" (151.0)	6.05" (155.0)	7.33" (188.0)
C	2.77" (71.0)	3.08" (79.0)	3.32" (85.0)	3.63" (93.0)
D	0.66" (17.0)	0.66" (17.0)	0.66" (17.0)	0.96" (24.5)

	Receptacle			
	16A			32A
	3-Wire	4-Wire	5-Wire	3-Wire
A	2.44" (62.0)	2.93" (75.0)	2.93" (75.0)	2.93" (75.0)
B	1.88" (47.0)	2.34" (60.0)	2.34" (60.0)	2.34" (60.0)
C	0.22" (5.5)	0.22" (5.5)	0.21" (5.5)	0.21" (5.5)
D	1.99" (51.0)	2.07" (53.0)	2.07" (53.0)	2.42" (62.0)
E	0.27" (7.0)	0.27" (7.0)	0.27" (7.0)	0.31" (8.0)
F	0.66" (17.0)	1.01" (26.0)	0.66" (17.0)	1.40" (36.0)
G	2.73" (70.0)	3.12" (80.0)	3.32" (85.0)	3.51" (90.0)
H	1.76" (45.0)	1.76" (45.0)	2.15" (55.0)	2.34" (60.0)

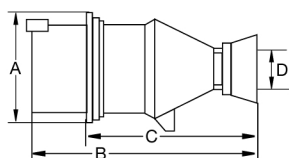

Plug

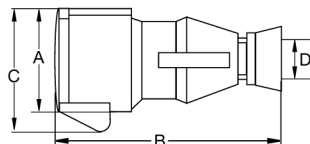

Connector

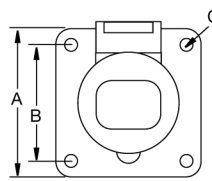

Receptacle

